

# The Menu Control Panel

Mounted to the back of each Pinvision is a 6 button control panel. If you are staring at the pinvision on your game, it should be on the upper right corner, accessible if you slide the playfield out into service position.

The buttons are laid out as follows:

**[AUTO] [MENU] [LEFT] [RIGHT] [EXIT/SELECT] [ON/OFF]**

So, if you're working from the front of the panel and reaching around the back, the buttons are opposite:

**[ON/OFF] [EXIT/SELECT] [RIGHT] [LEFT] [MENU] [AUTO]**

This control panel is adhered to the panel and is usually best left attached. The unit is detached in the pictures below for clarity of orientation. The order of the buttons shown from left to right on the below pictures is the same as if you were reaching over the top of the unit and using the buttons.

# Language Adjustment

To adjust the language of the panel menu, press the [MENU] button

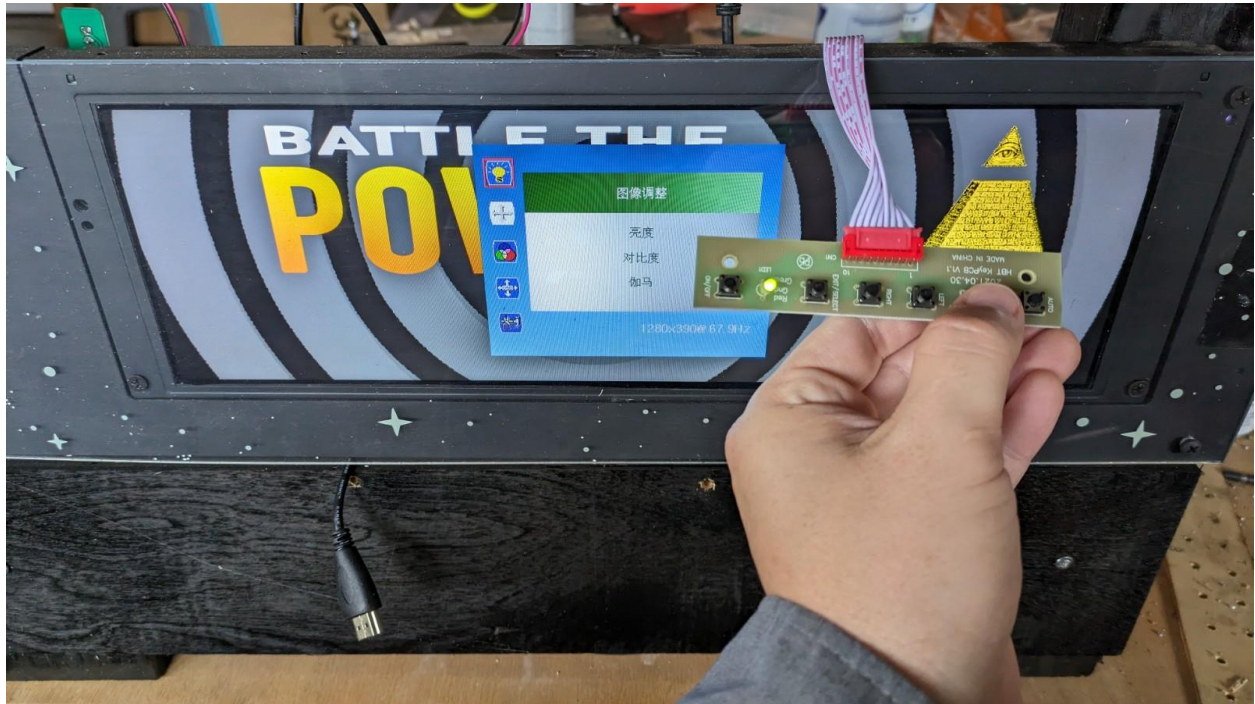

Scroll down using the [LEFT] or [RIGHT] buttons to the last entry and hit [MENU] again

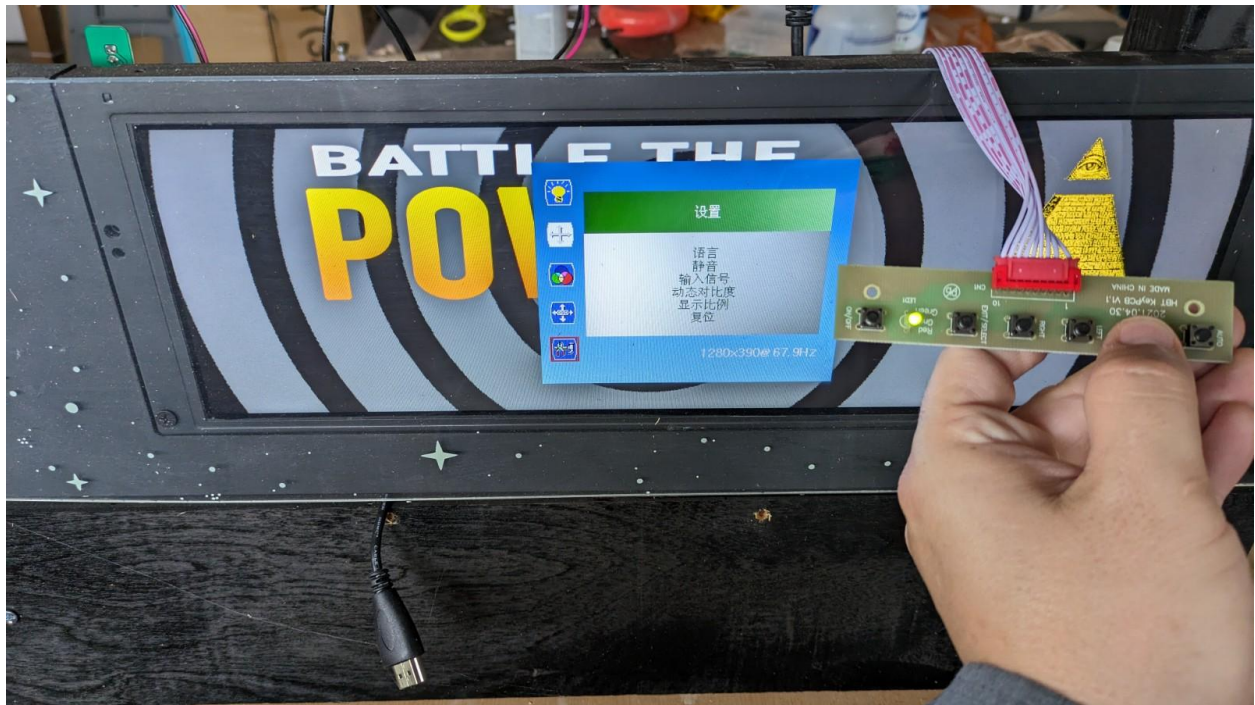

Select the first option by hitting [MENU] again





Use the [LEFT] or [RIGHT] buttons to select “English” mode. Hit [MENU] to select “English” once it’s highlighted.

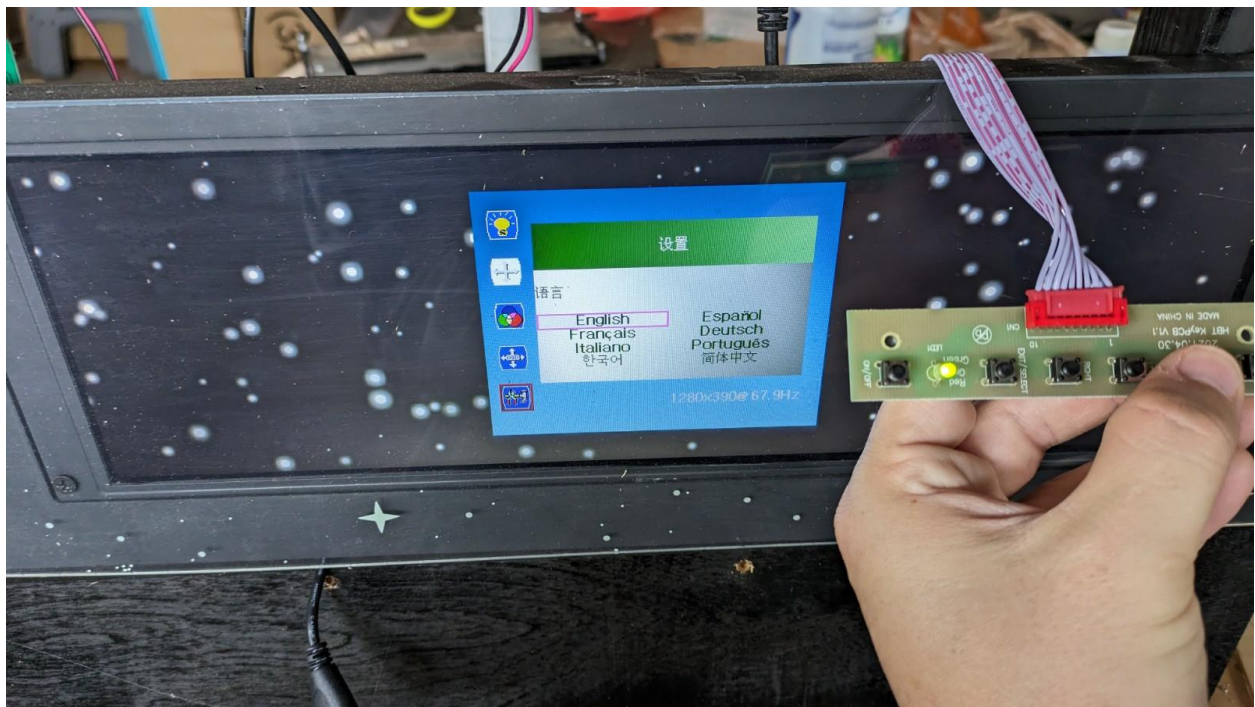

You can hit the “Exit” buttons or let the menu time out after about 5 seconds.

## Brightness Adjustment

First, hit [MENU] to bring up the adjustment menu. Then press [MENU] again to select the first option.

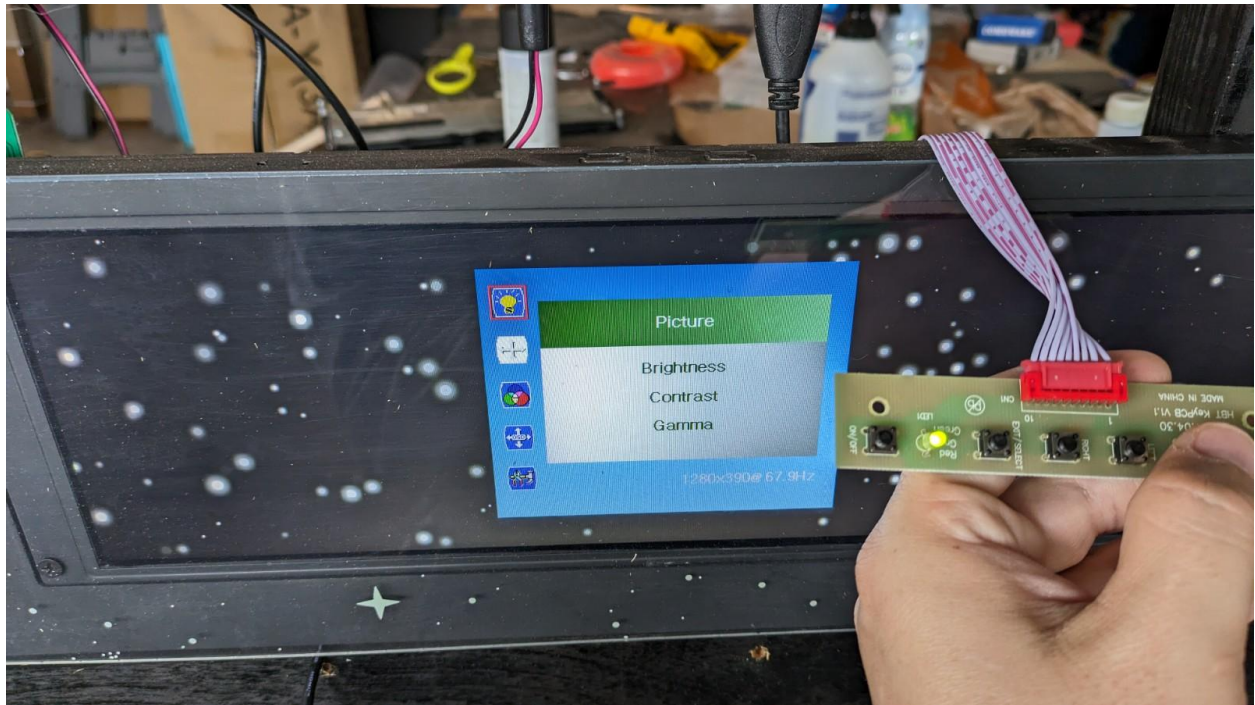



Hit [MENU] again to select the brightness adjustment, use the [LEFT] or [RIGHT] buttons to adjust the brightness up or down.

